

Essence SH-3232

Model number:

148018

Dimensions: 32" x 32" x 76"

Installation: Alcove

Material: AcrylX™ Ap-



Standard Features:

- 4-piece shower with low threshold base
- Large top corner shelves, footrests and standard acrylic handle
- Unique feature: PIN system for easy front installation
- Optional wall reinforcement and grab bars
- Base only without PIN system also available for tile application

Product characteristics:

- Made in Canada
- Multi-Piece Unit
- Easy Installation

Warranty:

25 Years

Standard colors:



White (002)



Bone (004)



Biscuit (007)

Certifications

MAAX products adhere to one or more of the following certifications:



Recommended doors (Visit our website for a complete list of our recommended doors)

| Description | No |
|-------------|--|
| 136447 | Kleara 1-panel Pivot Shower Door 27 ½-29 ½ x 69 in. 6 mm |
| 105416 | Madono Pivot Shower Door 28 ½-30 ½ x 67 in. 6 mm |
| 136635 | Pivolok Pivot Shower Door 27-28 ¾ x 64 ½ in. |

Options (Visit our website for a complete list of our options)

| No | Description |
|--------------------------------------|--|
| <input type="checkbox"/> OPT 10109 | One 12-in. handle with metallic finish |
| <input type="checkbox"/> OPT 20197 | Left Wall reinforcement |
| <input type="checkbox"/> OPT 20198 | Right Wall reinforcement |
| <input type="checkbox"/> OPT 20199 | Back Wall reinforcement |
| <input type="checkbox"/> OPT 20203-B | 18" Modern horizontal straight grab bar on back wall |

Essence SH-3232

Model number:

148018

Dimensions: 32" x 32" x 76"

Installation: Alcove

Material: AcrylX™ Ap-

1

Dimensions:

31 7/8 x 32 x 76 in.
(810 x 813 x 1930 mm)

Weight:

122 lbs - 55 kg

Shape:

Square

Pieces:

4

Drain location:

No seat, center drain

STANDARD

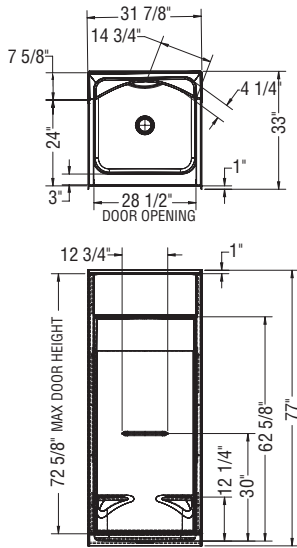

REINFORCEMENT BACKING

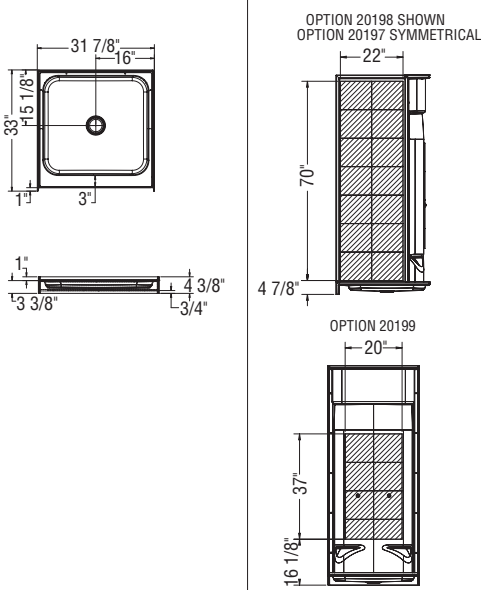

GRAB BARS

OPTION 20203

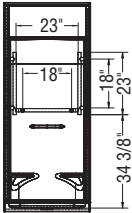

OPTION 20204

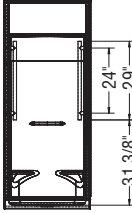

OPTION 20203-20204

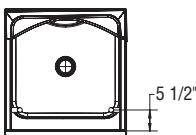

All dimensions are approximate. Structure measurements must be verified against the unit to ensure proper fit.
* Dimensions indicated on product pages exclude tiling flanges.

Project:

Contractor:

Representative:

Date:

Tel:

Notes: